



SITE LOCATION
E:455317 N:101999

NOTES

- DO NOT SCALE FROM THIS DRAWING
- ALL DIMENSIONS IN METRES UNLESS OTHERWISE STATED
- DRAWING TO BE REPRODUCED IN COLOURS

KEY

SITE CLEARANCE:

- x — EXISTING KERB TO BE TAKEN UP AND DISPOSED OFF SITE (58m)
- [Stippled pattern] EXCAVATE EXISTING VERGE TO A DEPTH OF 120mm FOR TYPE 1A FULL DEPTH FOOTWAY CONSTRUCTION (49m²)
- [Diagonal hatching] EXCAVATE EXISTING FOOTWAY AND RE-PROFILE FOR DROPPED ACCESS WITH TYPE 1A FULL DEPTH FOOTWAY CONSTRUCTION (7m²)
- [Cross-hatching] BREAK OUT EXISTING FOOTWAY TO A DEPTH OF 20mm FOR FOOTWAY INLAY RESURFACING (16m²)

PROPOSED:

- [Solid line] PROPOSED TYPE PC1 PRECAST CONCRETE KERB TO STANDARD DETAIL HCC10/C/010 (5m)
- [Dashed line] PROPOSED PRECAST CONCRETE EDGING TO STANDARD DETAIL HCC10/C/045 (50.4m)
- [Stippled pattern] PROPOSED TYPE 1A FULL DEPTH FOOTWAY CONSTRUCTION TO STANDARD DETAIL HCC10/C/045 (49m²)
- [Diagonal hatching] PROPOSED TYPE 1A FULL DEPTH FOOTWAY CONSTRUCTION TO STANDARD DETAIL HCC10/C/045 (7m²)
- [Cross-hatching] PROPOSED FOOTWAY INLAY RESURFACING 20mm AC6 DENSE SURF 100/150 MIN PSV 45 (16m²)
- [Grid pattern] PROPOSED LADDER PAVING (5m²)

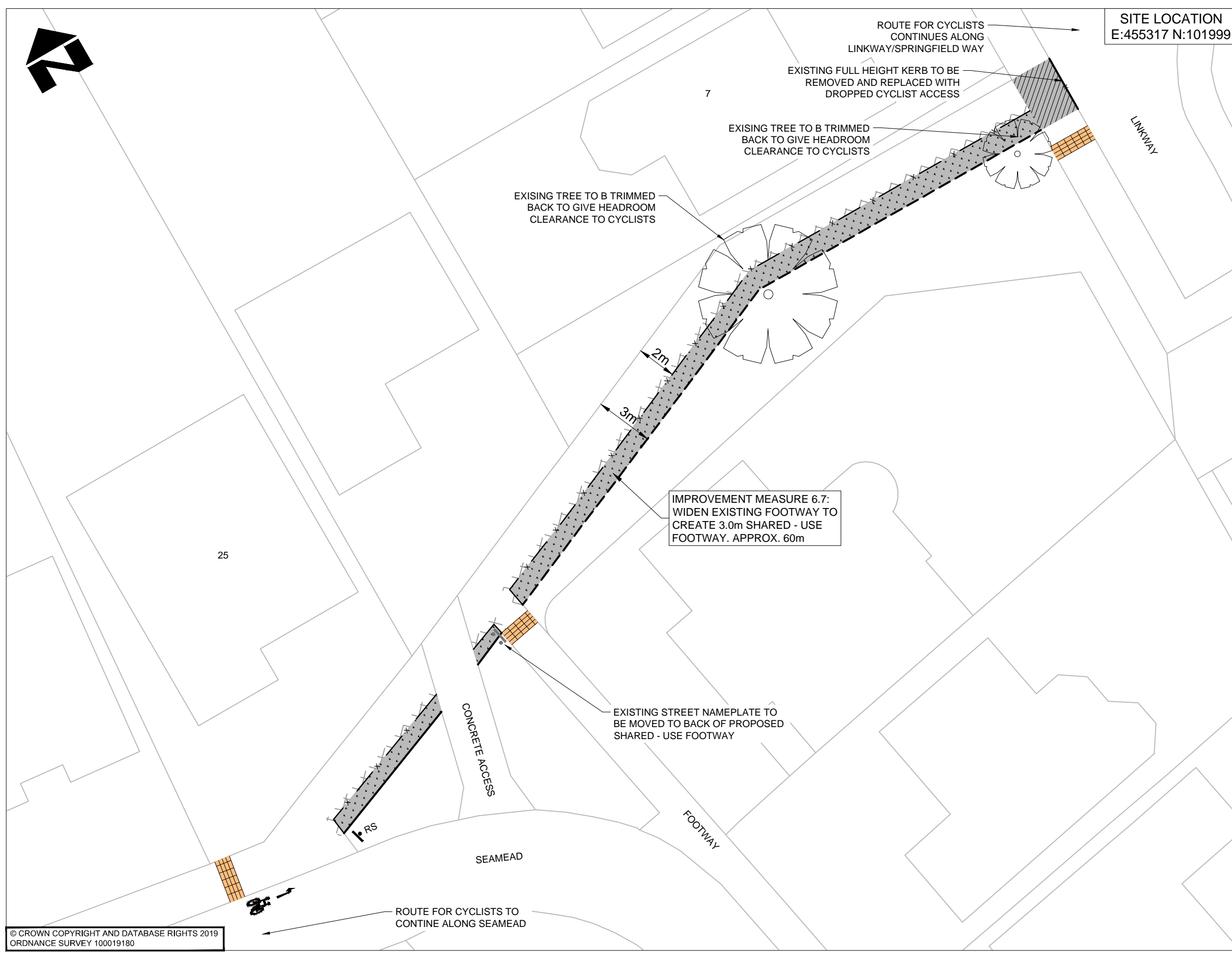

© CROWN COPYRIGHT AND DATABASE RIGHTS 2019
ORDNANCE SURVEY 100019180

CLIENT

HAMPSHIRE COUNTY COUNCIL
ECONOMY, TRANSPORT AND ENVIRONMENT DEPARTMENT
STRATEGIC TRANSPORT

CONSULTANT

Hampshire **Engineering**
County Council CONSULTANCY

STUART JARVIS BSc DipTP FCIHT MRTPI: DIRECTOR OF ECONOMY, TRANSPORT & ENVIRONMENT

DESIGNER GC
SCALE @ A3 1:200
CAD GC
DATE 04.01.2019
CHECKED PJ PJ
SHEET NUMBER 1 OF 1
APPROVED JR

SCHEME
GOSPORT & FAREHAM
LOCAL CYCLING
AND WALKING
INFRASTRUCTURE PLAN

JOB No. R.J507361

DRAWING TITLE
PRELIMINARY DESIGN
SECTION H

HCC CAD PLOT: 25/1/2019 16:20:11

SUIT REV
S2 P01